

# SDI ENGINEERING

A Limited Liability Company

TBPE Licensed No F-13016

Civil • Transportation • Planning • Stormwater

5602 E. Iowa Road, Edinburg, Texas 78542 (956) 287-1818 office (956) 287-3697 fax

## ADDENDUM NO. 1

**DATE:** March 15, 2019

**RE:** BID NO. 19-95 – Vision Academy Paving, Drainage and Lighting Improvements

**OWNER:** EDINBURG CISD

**TO:** ALL PROPOSERS, HOLDERS OF SPECIFICATIONS, AND ALL INTERESTED PARTIES TO THE EDINBURG CISD

**BID OPEN:** 3:00 P.M. (Central Time), Thursday, March 21, 2019

The following clarifications, corrections and directives shall become part of the Proposal, Contract Documents and Specifications for **BID NO. 19-95 – Vision Academy Paving, Drainage and Lighting Improvements.**

### CLARIFICATIONS/MODIFICATIONS

1. Plan Sheet 8 of 20 – See attached Detail for Gate.

### BID PROPOSAL

2. *Replace Bid Proposal Form, Pages 8 to 14 with Bid Proposal Form (Revised), 8 to 15 (SEE ATTACHED), which includes the following changes:*
  - a. Revised Item No. 35 to exclude Fire Alarm System
  - b. Added Item No. 39 (Add Alternate No. 1) – Fire Alarm System

### CONSTRUCTION PLANS

3. *Replace Plan Sheet 9 of 20 with Revised Plan Sheet 9, which includes the following change:*
  - a. Bore 90 LF of 16" Steel Casing with 8" Fire Line

### MEP PLANS AND SPECIFICATIONS

4. See attached MEP Addendum No. 1

Please make the necessary corrections to the Plans and Proposal, as appropriate.

**PLEASE ACKNOWLEDGE RECEIPT OF THIS ADDENDUM IN THE SPACE PROVIDED IN THE BID PROPOSAL FORM.**



SCHUNIOR ROAD (FM 2128)

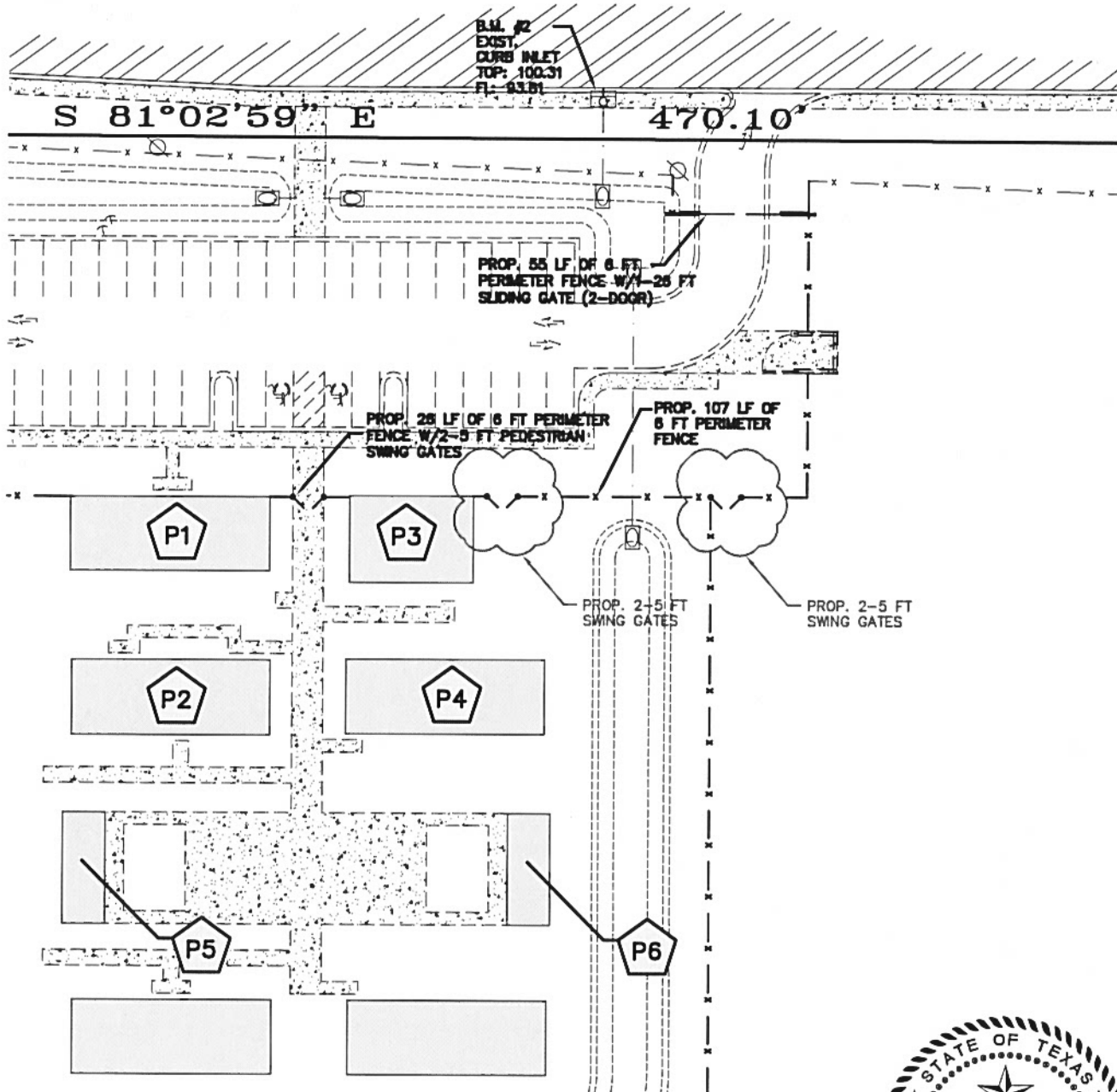

EXHIBIT "A"  
FENCE DESCRIPTION

**SDI ENGINEERING, LLC**

CIVIL • TRANSPORTATION • PLANNING • STORMWATER  
5602 E. IOWA RD., EDINBURG, TEXAS 78542 (956) 287-1818 PH. (956) 287-3697 FAX  
INFO@SDI-ENGINEERING.COM  
TBPB REG. NO. F-13016



*Israel Posadas*  
3/15/19.  
THE SEAL APPEARING ON THIS DOCUMENT WAS AUTHORIZED BY ISRAEL POSADAS, P.E. No. 89435 ON MARCH 15, 2019. ALTERATION OF A SEALED DOCUMENT WITHOUT PROPER NOTIFICATION OF THE RESPONSIBLE ENGINEER IS AN OFFENSE UNDER THE TEXAS ENGINEERING PRACTICE ACT.

**ORIGINAL BID PROPOSAL FORM MUST BE SUBMITTED ALONG WITH THE BID AND  
CONTRACT DOCUMENTS BOOKLET**

BIDDERS BOND in the amount of \$\_\_\_\_\_,(5%) of the greatest amount bid in compliance with the INSTRUCTION TO BIDDERS.

The above Cashiers Check or Bidder's Bond is to become the property of the OWNER, in the event the construction contract (when offered by the Owner) and bonds are not executed within the time set forth.

**IMPORTANT NOTE:**

For information regarding the method UNIT ITEMS are to be MEASURED AND PAID, please refer to the "MEASUREMENT AND BASIS OF PAYMENT" Section attached and made part of this Proposal.

**A. PAVING IMPROVEMENTS**

Item No.	Estimated Quantity	Unit	Item Description	Unit Price	Total
1.	1	LS	<b>Preparation of Project Limits/Demolition Plan</b> , Clearing, Demolition, grubbing, tree and shrub removal, structure removal including all appurtenances, fence removal and fine grading, including compaction, all necessary additional fills and cuts, hauling and spreading of select material to the limits indicated in the plans all complete in place per Lump Sum (LS) for	\$_____	\$_____
2.	560	SF	<b>Reinforced Concrete Drive with Apron</b> , 6" thick, joints and joint sealer, 6" lime treated (1% by weight) subgrade, grading, all as per the plans and specifications for the width shown, all complete in place per Square Foot (SF) for	\$_____	\$_____
3.	2,250	SY	<b>6" Compacted Lime Treated Subgrade</b> , with lime (4% lime by weight), compacted as per plans and specifications, conforming to TX-DOT 2004 Standard Specification Item 260, complete and in place per Square Yard (SY) for	\$_____	\$_____
4.	2,250	SY	<b>8 " Compacted Flexible Base</b> , Type "E" Grade 4, compacted as per plans and specifications, conforming to TX-DOT 2004 Standard Specification Item 247, complete and in place per Square Yard (SY) for	\$_____	\$_____

5.	1,830.30	SY	<b>2" Compacted Hot-Mix Asphaltic Concrete</b> , Type "D" surface course conforming to TX-DOT 2004 Standard Specification Item 340, including MC-30 Prime Coat, and Tack Coat, all complete in place per Square Yard (SY) for	\$ _____	\$ _____
6.	950	LF	<b>18" Concrete Curb and Gutter including Laydown Curb</b> , as per plans and specifications, all complete and in place per Linear Foot (LF) for	\$ _____	\$ _____
7.	4	EA	<b>Concrete Spillways</b> , installed as per the plans and specifications, complete in place per Each (EA) for	\$ _____	\$ _____
8.	4	EA	<b>Cast in Place Reinforced Concrete Safety End Treatments</b> , installed as per the plans and specifications, complete in place per Each (EA) for	\$ _____	\$ _____
9.	4,460	SF	<b>Reinforced Concrete Sidewalks (Schunior St.)</b> , 4" thick, including handicap ramps, concrete curb at handicap ramps, joints and joint sealer, 2" sand base, grading, truncated domes according to ADA requirements, all as per the plans and specifications for the width shown, all complete in place per Square Foot (SF) for	\$ _____	\$ _____
10.	8,700	SF	<b>Reinforced Concrete Sidewalks (Interior)</b> , 4" thick, including handicap ramps, concrete curb at handicap ramps, joints and joint sealer, 2" sand base, grading, truncated domes according to ADA requirements, all as per the plans and specifications for the width shown, all complete in place per Square Foot (SF) for	\$ _____	\$ _____
11.	4	EA	<b>Concrete Drain Chutes</b> , installed as per the plans and specifications, complete in place per Each (EA) for	\$ _____	\$ _____
12.	1	LS	<b>Thermoplastic Pavement Striping / Markings and Signage</b> , including ADA parking spaces, crosswalks, directional arrows parking lot striping, new concrete wheel stops, and other traffic control sign assemblies as indicated in the plans and specifications, all complete and in place per Lump Sum (LS) for	\$ _____	\$ _____

**TOTAL PAVING IMPROVEMENTS:** (Items 1-12) \$ \_\_\_\_\_

### B. WATER AND SEWER IMPROVEMENTS

Item No.	Estimated Quantity	Unit	Item Description	Unit Price	Total
13.	520	LF	<b>2-inch Domestic Water Service – (SDR 9, HDPE, 200 psi – ASTM D2737 &amp; C901)</b> , including tapping connection to 8" Fire Line, water meter, line installation from meters to buildings, coordination with City of Edinburg, as per plans and City of Edinburg standards, all complete and in place per Linear Foot (LF) for	\$ _____	\$ _____
14.	830	LF	<b>6-inch Sanitary Sewer Services</b> , Schedule 40, installed as per plans and City of Edinburg standards, all complete and in place per Linear Foot (LF.) for	\$ _____	\$ _____
15.	3	EA	<b>Sanitary Sewer Cleanouts</b> , installed as per the plans and specifications, complete in place per Each (EA) for	\$ _____	\$ _____
16.	1	LS	<b>Connect to Existing Sanitary Sewer Manhole</b> to grade including ring, cover, and risers according to City of Edinburg requirements, complete in place per Lump Sum (LS) for	\$ _____	\$ _____
17.	1,350	LF	<b>Trench Safety System</b> , for Storm Sewer Lines/Excavations ad required, complete in place per Linear Foot (LF) for	\$ _____	\$ _____

**TOTAL WATER AND SEWER IMPROVEMENTS:** (Item 13-17) \$ \_\_\_\_\_

### C. FIRE LINE IMPROVEMENTS

Item No.	Estimated Quantity	Unit	Item Description	Unit Price	Total
18.	95	LF	<b>8" C-900 DR25, PVC water main</b> , including backfill, compaction, boring across Schunior Rd. with 16" steel casing (as per TxDOT requirements) to meter location installed as per plans and specifications, per City of Edinburg Standards, all complete in place per Linear Foot (LF) for	\$ _____	\$ _____
19.	1	EA	<b>Fire Hydrant</b> , including all materials labor and equipment, all complete in place Each (EA) for	\$ _____	\$ _____

20.	1	EA	<b>Connect to Existing Waterline</b> , all depths, including cut-in tees, megalug restraint system, thrust blocking, material, backfill, compaction, installed as per plans and specifications, per City of Edinburg Standards all complete in place per Each (EA) for	\$ _____	\$ _____
21.	95	LF	<b>Trench Safety System</b> , for Storm Sewer Lines/Excavations ad required, complete in place per Linear Foot (LF) for	\$ _____	\$ _____

**TOTAL FIRE LINE IMPROVEMENTS:** (Item 18-21) \$ \_\_\_\_\_

**D. DRAINAGE IMPROVEMENTS**

Item No.	Estimated Quantity	Unit	Item Description	Unit Price	Total
22.	200	LF	<b>15" RCP, Class III</b> , all depths, "Rubber Gasket" joints, backfill, compaction, all connections, installed as per plans and specifications, all complete and in place per Linear Foot (LF) for	\$ _____	\$ _____
23.	4	EA	<b>Cast in Place Reinforced Concrete Safety End Treatments</b> , installed as per the plans and specifications, complete in place per Each (EA) for	\$ _____	\$ _____
24.	40	LF	<b>8" RCP, Bleeder Line</b> , all depths, "Rubber Gasket" joints, backfill, compaction, all connections, installed as per plans and specifications, as per TxDOT requirements, all complete and in place per Linear Foot (LF) for	\$ _____	\$ _____
25.	2	EA	<b>Precast Curb Reinforced Inlet Type "A"</b> , installed as per the plans and specifications, complete in place per Each (EA) for	\$ _____	\$ _____
26.	200	LF	<b>Trench Safety System</b> , for Storm Sewer Lines/Excavations ad required, complete in place per Linear Foot (LF) for	\$ _____	\$ _____

**TOTAL DRAINAGE IMPROVEMENTS:** (Item 22-26) \$ \_\_\_\_\_

**E. IRRIGATION, FENCING AND OTHER IMPROVEMENTS**

Item No.	Estimated Quantity	Unit	Item Description	Unit Price	Total
27.	1	LS	<b>Landscaping</b> , as per plans and specifications, including any trees, plants, shrubs, mulch, hydromulching or seeding of general areas, irrigation system, all complete in place per Lump Sum (LS) for	\$ _____	\$ _____
28.	1	LS	<b>Irrigation System</b> , with connection to 8" Fire Line, irrigation meter, designed and installed by a licensed and registered irrigation professional, <b>(plans represent a schematic layout with minimum performance requirements)</b> , including System Controller, Vacuum Breaker, Control Valves, Irrigation Main, Laterals, Pop Up Heads, and quick connects, all complete and in place per Lump Sum (LS) for	\$ _____	\$ _____
29.	990	LF	<b>6' Chain Link Fence</b> , as per plans and specifications including modification of gate opening, all materials, labor and equipment for the fabrication, installation locking mechanisms, railing with required supports, wheels, all complete in place per Linear Foot (LF) for	\$ _____	\$ _____
30.	4	EA	<b>6' Pedestrian Swing Gate</b> , as per plans and specifications including modification of gate opening, all materials, labor and equipment for the fabrication, installation, locking mechanisms, railing with required supports, wheels, all complete in place per Each (EA) for	\$ _____	\$ _____
31.	4	EA	<b>5' Pedestrian Swing Gate</b> , as per plans and specifications including modification of gate opening, all materials, labor and equipment for the fabrication, installation, locking mechanisms, railing with required supports, wheels, all complete in place per Each (EA) for	\$ _____	\$ _____

32.	2	EA	<b>26' Double Sliding Gates (vehicular entrances)</b> , as per plans and specifications including modification of gate opening, all materials, labor and equipment for the fabrication, installation, locking mechanisms, railing with required supports, wheels, all complete in place per Each (EA) for	\$ _____	\$ _____
33.	1	EA	<b>30-Foot Aluminum Flag Pole</b> , as per plans and specifications including concrete foundation, and flag pole, (color to be selected by owner) all complete in place per Each (EA) for	\$ _____	\$ _____
34.	1	LS	<b>Masonry Dumpster Enclosure</b> , as per plans and specifications including concrete pad, side walls and front rolling and locking gate, and bollards, painted (color to be selected by owner) as per City of Edinburg requirements, all complete and in place per Lump Sum (LS) for	\$ _____	\$ _____

**TOTAL IRRIGATION, FENCING AND OTHER IMPROVEMENTS:** (Item 27-34) \$ \_\_\_\_\_

**F. LIGHTING AND ELECTRICAL**

Item No.	Estimated Quantity	Unit	Item Description	Unit Price	Total
35.	1	LS	<b>Contractor Shall Include</b> in his bid all materials and labor required to install new light fixtures, light poles, controls, transformers, and associated equipment including all permits and other fees, <u>(excluding Fire Alarm System as this is covered in Add Alternate No. 1)</u> for a complete working system as shown on plans and specifications all complete and in place per Lump Sum (LS)	\$ _____	\$ _____

**TOTAL LIGHTING & ELECTRICAL IMPROVEMENTS:** (Item 35) \$ \_\_\_\_\_

**G. MISCELLANEOUS ITEMS**

Item No.	Estimated Quantity	Unit	Item Description	Unit Price	Total
36.	1	LS	<b>Stormwater Pollution Prevention Plan (SWPPP) and Stormwater Permit</b> as per City, State and Federal requirements, including required inspections, all complete for the term of the project for a Lump Sum (LS) for	\$_____	\$_____
37.	1	LS	<b>Erosion Control Devices</b> , as per the approved SWPPP for the entire Project, all complete in place including maintenance and removal after the Project for a Lump Sum (LS) for	\$_____	\$_____
38.	1	LS	<b>Traffic Control</b> , for entire project including roadway crossings, signage, detours, temporary drive installation, permits, Traffic Control Plan prepared by a Registered Professional Engineer, all in accordance with the Texas Manual on Uniform Traffic Control Devices (TMUTCD, latest edition), all complete in place per Lump Sum (LS) for	\$_____	\$_____

**TOTAL MISC. IMPROVEMENTS:** (Items 36-38)\$ \_\_\_\_\_

**TOTAL BASE BID:** (Items 1-38) \$ \_\_\_\_\_

**ADD ALTERNATES****H. ADD ALTERNATE NO. 1 – FIRE ALARM**

Item No.	Estimated Quantity	Unit	Item Description	Unit Price	Total
39.	1	LS	Fire Alarm System, as per plans and specifications, all complete in place per Lump Sum (LS) for	\$_____	\$_____

**TOTAL ADD ALT. NO. 1:** (Items 39)\$ \_\_\_\_\_

**TOTAL BID:** (Items 1-39) \$ \_\_\_\_\_

The undersigned agrees, unless hereinafter stated otherwise to furnish all materials as shown and specified in the Plans and Specifications.

Bidder hereby agrees to commence work under this contract within 10 days after "NOTICE TO PROCEED" is issued, and to complete all the work in the Contract within 120 Calendar Days.

The undersigned bidder acknowledges the receipt of the following addenda:

ADDENDUM NO.	DATE	BY
ADDENDUM NO. 1		
ADDENDUM NO. 2		
ADDENDUM NO. 3		
ADDENDUM NO. 4		

Date: \_\_\_\_\_

By: \_\_\_\_\_  
(Signature)

\_\_\_\_\_  
(Type or Print Name)

\_\_\_\_\_  
(Title)

\_\_\_\_\_  
(Company)

\_\_\_\_\_  
(Address)

\_\_\_\_\_  
(City, State, Zip)

\_\_\_\_\_  
(Phone Number)

\_\_\_\_\_  
(Fax Number)

(Seal – if Bidder is a Corporation)



**ADDENDUM 1**

**Date:** 03-14-2019

**From:** Sigma HN Engineers  
701 South 15th Street  
McAllen, TX 78501

**Project:** Bid No. 19-95 Vision Academy Paving, Drainage and Lighting Improvements

**TO:** Prospective Bidders  
This Addendum forms a part of the Contract Documents and modifies the Bidding Documents dated 02.27.2019 with amendments and additions noted below.



---

The following is a list of changes made to the plans and specifications. The changes are outlined by item number, as well as plan sheet number.

**CHANGES TO THE PROJECT MANUAL:**

- ITEM 1 Refer to specification section 283111 Digital Fire Alarm System:
- a. Change the fire alarm system to and added alternate.

**CHANGES TO THE DRAWINGS:**

- ITEM 1 Refer to sheet TS-1.0, Telecom site Plan, Detail 02:
- a. Change the fire alarm system to and added alternate.

**ATTACHMENTS:**

Sheets: None  
Forms: None